

~\$1.35 psf
\$1,755/month

FOR
LEASE

- Multi-Tenant Industrial
- Year Built: 1976
- Two Offices
- Restroom
- 100-A Single-Phase Power
- 12' High Clearance
- 10'x10' Overhead Door
- Parking: 3 Reserved
- Warehouse & Distribution Uses
- Minutes to the 118 & 101 Freeways
- Term: 1 to 3 years
- No CAMs

1,300 sf Industrial Warehouse WEST VALLEY INDUSTRIAL Two Offices plus Restroom

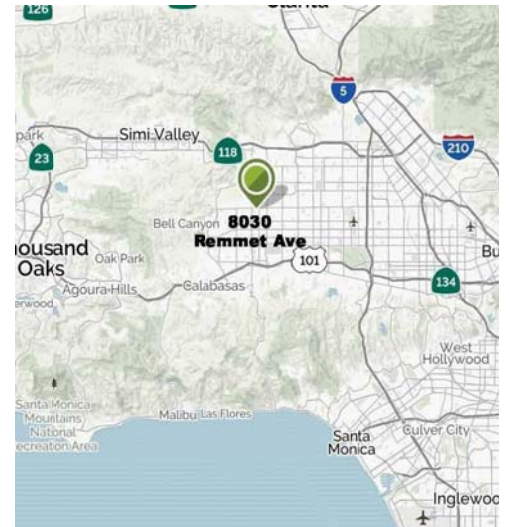
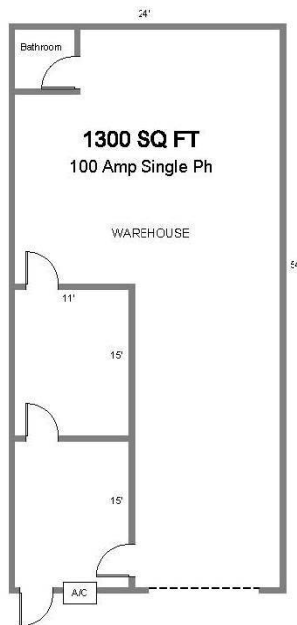

AVAILABLE 3/15/2018

8030 Remmet #14, Canoga Park, CA 91304



CA CalBRE #01264732

Features Include: Two Offices with one wall A/C, Evaporative Cooler & Gas Space Heater in Warehouse, Restroom, 10'x10' Overhead Door, Parking: Three (3) Reserved Spaces, Clearance: 12 ft.

Additional Information:
Tenant pays for Electricity, Gas, Trash, Phone & Internet

Preferred Term: 1 to 3 Years
Subject to Credit & Financial Approval

Jeremy Wacker (CalBRE #01986677)
Tim Simpson (CalBRE #020121368)

(818) 717-0200

See our other Listings at
www.tscorealestate.com