

~\$1.25 psf  
\$3,000/month

FOR  
LEASE

- Multi-Tenant Industrial
- Year Built: 1973
- Entry Office ~170 sq ft
- Restroom
- 100-A Single-Phase Power
- 12' High Clearance
- 12'wx10'h Overhead Door
- Parking: 3 Reserved
- Warehouse & Distribution Uses
- Minutes to the 118 & 101 Freeways
- Term: 1 to 3 years
- No CAMs

## 2,400 sf Industrial Warehouse REMMET INDUSTRIAL Entry Office plus Restroom

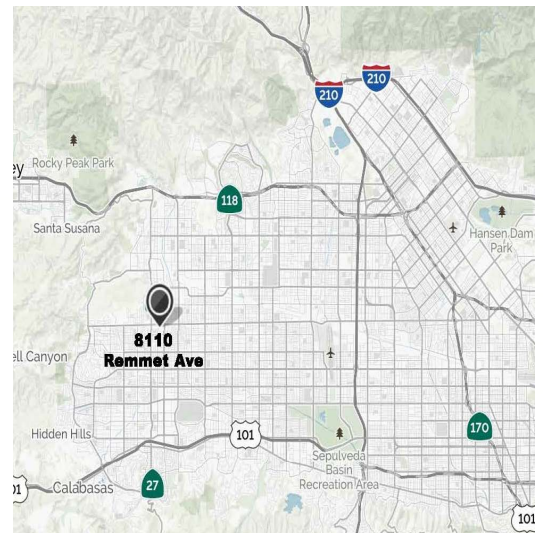
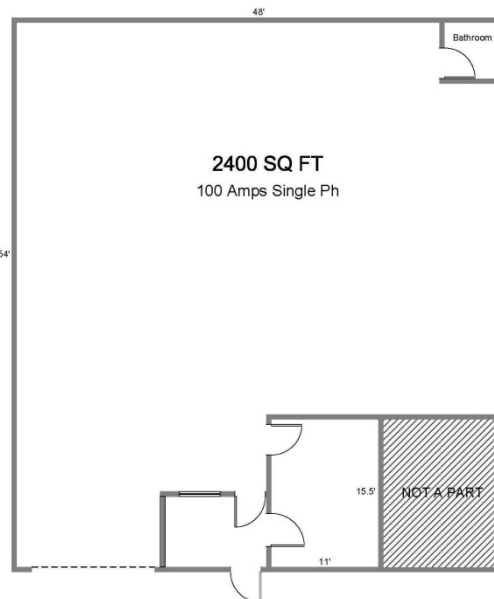

AVAILABLE 9/1/2017

### 8110 Remmet #3, Canoga Park, CA 91304



CA CalBRE #01264732

**Features Include:** Front Entry Office (about 11'x15' sf), Evaporative Cooler & Gas Space Heater in Warehouse, Restroom, 12'x10' Overhead Door, Parking: Three (3) Reserved Spaces, Clearance: 12 ft.

**Additional Information:**  
Tenant pays for Electricity, Gas, Trash, Phone & Internet

Preferred Term: 1 to 3 Years  
Subject to Credit & Financial Approval

**Christine Cabanting** (CalBRE #01133848)  
**Tim Simpson** (CalBRE #020121368)

**(818) 717-0200**

See our other Listings at  
[www.tscorealestate.com](http://www.tscorealestate.com)